

These documents must be retained on site. Inspections may not be carried out if they are not.

Key - displaying the existing fire alarm configuration

- No Alarm
- Type 2 Alarm (manual call points only)
- Type 3 Alarm (heat detectors and manual call points)
- Type 4 Alarm (smoke detectors and manual call points)
- Type 7 Alarm (sprinklers, smoke detectors and manual call points)

Note 1: The building with the Type 7 alarm is not proposed to be upgraded.

Note 2: All buildings to be upgraded to at least a Type 4 Alarm

Note 3: All buildings to communicate with the main site panel and display information on the mimic panel at the FENZ attendance point

Note 4: All sounders to have EWIS capabilities complying with AS 2220 and NZS 4512

Note 5: Fire alarm system to have direct connection to FENZ

Note 6: Photo optical smoke detectors are to be installed throughout

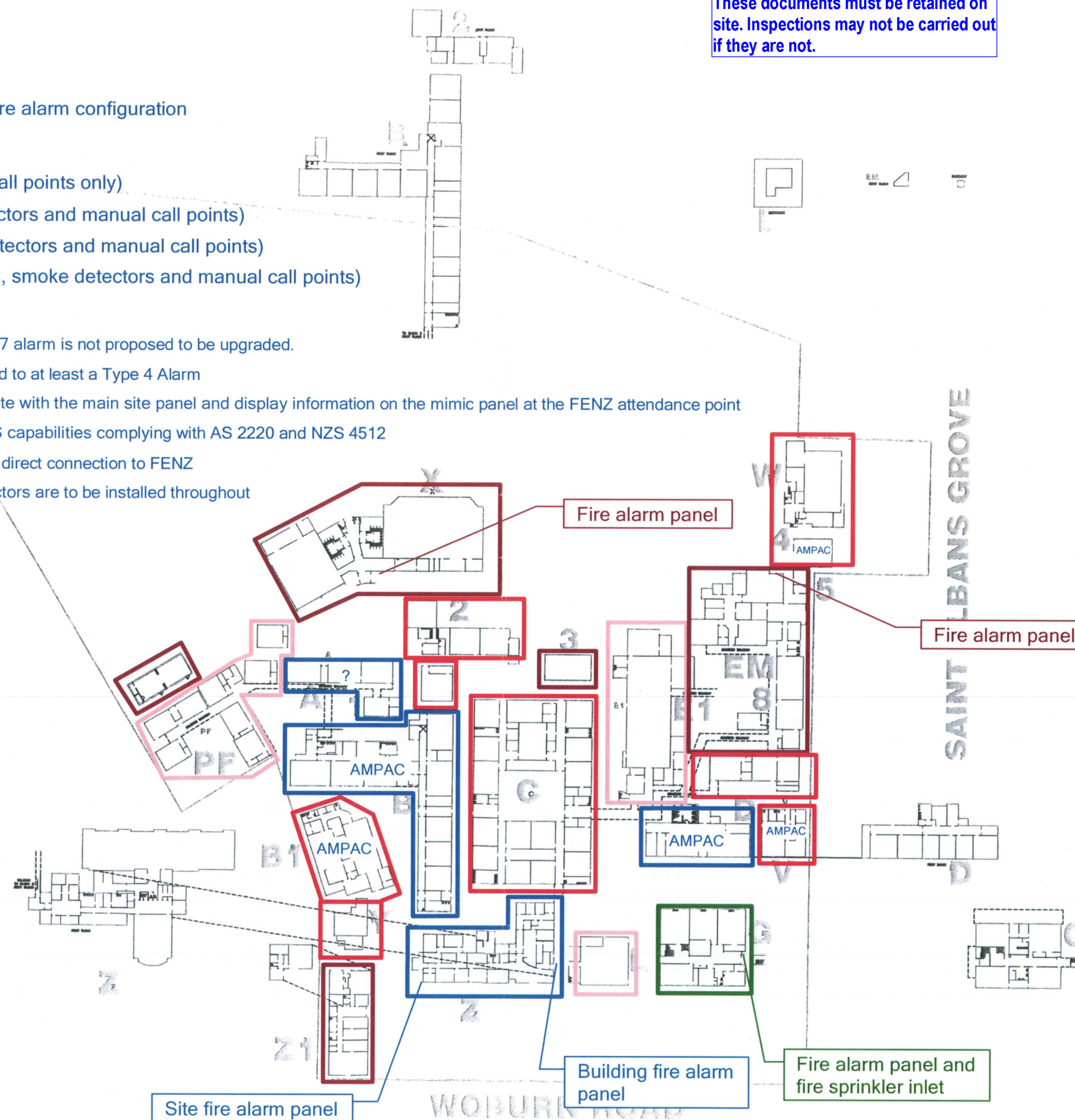

BUILDING CONSENT

GRANTED  
29/07/2019

HUTT CITY COUNCIL





## BUILDING CONSENT

GRANTED  
29/07/2019

HUTT CITY COUNCIL

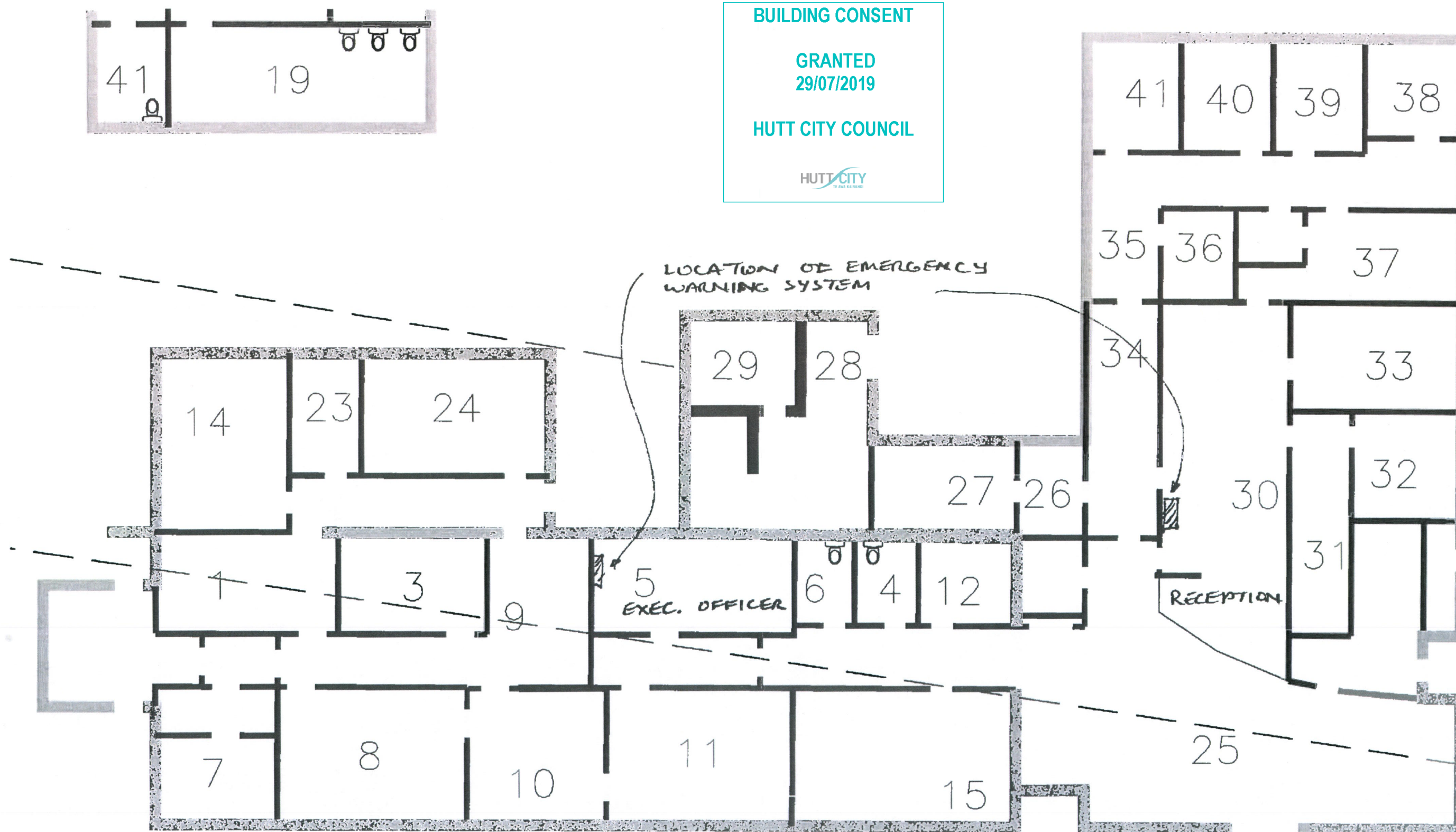

EWIS microphones are to be located in Rooms 5 and 30 as indicated above