

SUPPLEMENTARY AGREEMENT

Signed as a Deed.

This Supplementary Agreement is made on the 17th day of November 2021

between:

Her Majesty the Queen in right of New Zealand acting by and through the Minister of Education ("the Minister")

and

International Society for Krishna Consciousness Incorporated ("the Proprietor"),

together the Parties

in relation to ***HARE KRISHNA SCHOOL, KUMEU ("the School")***.

Background

- A. By an Integration Agreement dated **3 March 1992** between the Minister and the Proprietor ("**Integration Agreement**"), the School was established as a State integrated school.
- B. The Parties have agreed to amend the Integration Agreement on the terms below. The Integration Agreement will be read subject to the modifications set out in this Supplementary Agreement from the date this Supplementary Agreement is executed by the Parties, and any references to the Private Schools Conditional Integration Act 1975 will be treated as references to the corresponding provisions of the Education and Training Act 2020
-

Amendments

The Plan annexed to the Second Schedule of the Integration Agreement is deleted and replaced with the Plan annexed to this Supplementary Agreement.



Execution

Signed on the 25 day of October 2021 on behalf of the **International Society for Krishna Consciousness Incorporated** by **Eric Beecroft and Jay Matsya** and its common seal of affixed in the presence of:

[Signature] Trustee
[Signature] Trustee



in the presence of:

[Signature]

Name: Roneel Naidu

Occupation: IT consultant.

Location: Waimauke.

By signing this Supplementary Agreement, each representative of the Proprietor confirms that s/he has the authority to sign for and on behalf of the Proprietor, and that the Proprietor remains a body corporate with capacity to enter into this Supplementary Agreement clause 5(3) of Schedule 6 of the Education and Training Act 2020.

Signed on the 19th day of November 2021 by:

Her Majesty the Queen in right of New Zealand, acting by and through the Group Manager National Property Services, acting under delegated authority from the **Minister of Education**:

[Signature]

in the presence of:

Name:

Occupation:

Location:

[Signature]
Sarah Taylor
 Senior Advisor, Integrated Schools
 Ministry of Education, Wellington

JOB NO: 19-028

Address:
1229 COATESVILLE -
RIVERHEAD HIGHWAY
RIVERHEAD AUCKLAND
PT LOT 1 DP 29311

COUNCIL STAMP

A03 (2)

EX. SCHOOL SITE
PLAN

Scale: 1:500

Drawn by: Wesley S.

Checked by: Bobby B

Issue date: 20-03-20

22 Applewood Drive
Henderson
Auckland-0612

Ph: (09) 8360578
Fax: (09) 8360578
bobby@tarzandesign.co.nz
www.tarzandesign.co.nz

Copyright: Tarzan Design Ltd.

TARZAN DESIGN
ARCHITECTURAL SOLUTIONS

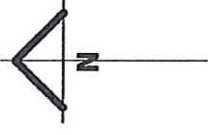

LEGEND	
	EX. BUILDING
	BUILDINGS WITHIN SCHOOL AREA
	PROP. PAVING AREA

NOTE:
ALL EXISTING BEARERS OF LIBRARY TO BE AS IS, SIZE & LOCATION OF NEW PILES AS PER EXISTING IN NEW LOCATION.

SITE PLAN OF SCHOOL PRECINCT HARE KRISHNA	
1229 COATESVILLE - RIVERHEAD HIGHWAY RIVERHEAD - AUCKLAND PT LOT 1 DP 29311	
GRAHAM READ CONSULTANTS CONSULTING LAND SURVEYORS PO BOX 643 - KUMIEU 0841 P 09 412 7383 M 021 752 071	
SCALE 1:500 (A3) DATE: DEC 2014	REF 3389P03

SITE AREA: Ex. Site area (School bdy)	= 12840m ²
BUILDING BUILT UP: Ex. built up area	= 1625m ²
Prop. built up area	= 203m ²
TOTAL BUILT UP AREA	= 1828m ²
TOTAL BUILT UP COVERAGE	= 14.30%
IMPERVIOUS AREAS: Ex. decks/steps/ramps	= 125m ²
Ex. paved areas	= 1265m ²
Prop. deck area	= 66m ²
Prop. paving area	= 157m ²
TOTAL IMPERVIOUS AREA	= 3441m ²
TOTAL IMPERVIOUS COVERAGE	= 26.80%

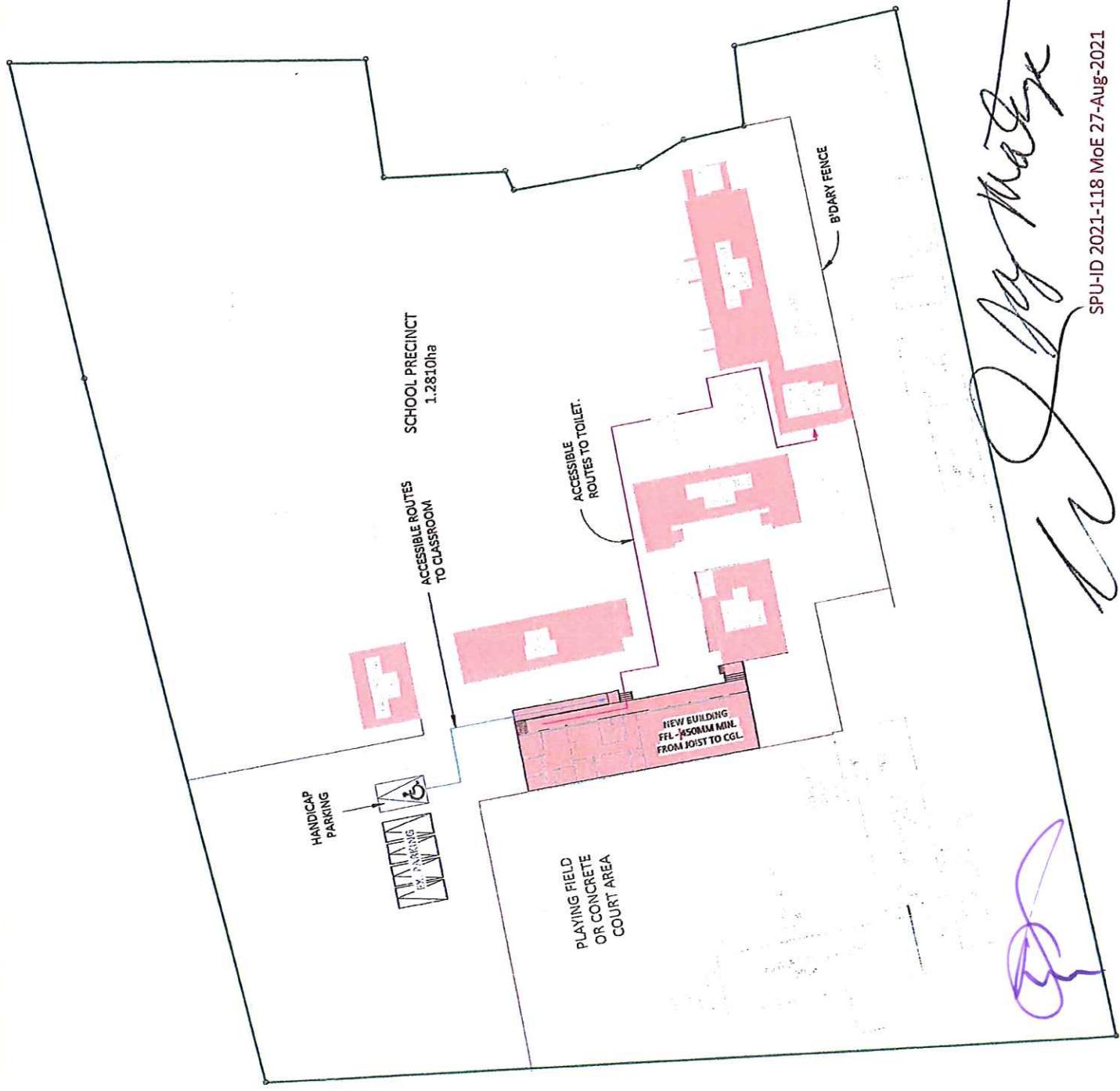

[Handwritten signature]

SPU-ID 2021-118 MoE 27-Aug-2021