

## SUPPLEMENTARY AGREEMENT

Signed as a Deed.

This Supplementary Agreement is made on the 16 day of March 2023

between:

**His Majesty the King in right of New Zealand** acting by and through the **Minister of Education** ("the Minister")

and

**Trinity Schools Trust Board** ("the Proprietor"),

together **the Parties**

in relation to **HADLOW PREPARATORY SCHOOL, MASTERTON** ("the School").

---

### Background

- A. By an Integration Agreement dated **22<sup>nd</sup> December 1998** between the Minister and the Proprietor ("**Integration Agreement**"), the School was established as a State integrated school.
- B. The Parties have agreed to amend the Integration Agreement on the terms below. The Integration Agreement will be read subject to the modifications set out in this Supplementary Agreement from the date this Supplementary Agreement is executed by the Parties, and any references to the Private Schools Conditional Integration Act 1975 will be treated as references to the corresponding provisions of the Education and Training Act 2020.

---

### Amendments

- 1 The Plan annexed to the Second Schedule of the Integration Agreement is deleted and replaced with the Plan annexed to this Supplementary Agreement.
- 

Initial



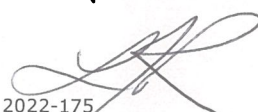

## 2 Execution

Signed on the 16 day of March 2023 on behalf of **Trinity Schools Trust Board** by **Lisa Rossiter** and **Matthew Boggs** and its common seal affixed in the presence of:

  
\_\_\_\_\_  
Trustee

  
\_\_\_\_\_  
Trustee

in the presence of:

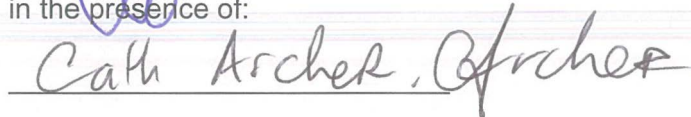
  
\_\_\_\_\_  
Cath Archer



TRINITY SCHOOLS TRUST BOARD

Name:

Occupation: chief Executive

Location: Masterton

By signing this Supplementary Agreement, each representative of the Proprietor confirms that s/he has the authority to sign for and on behalf of the Proprietor, and that the Proprietor remains a body corporate with capacity to enter into this Supplementary Agreement clause 5(3) of Schedule 6 of the Education and Training Act 2020.

Signed on the 27th day of March 2023 by:

**His Majesty the King in right of New Zealand**, acting by and through the Group Manager Infrastructure Advisory Group, acting under delegated authority from **the Minister of Education**:

  
\_\_\_\_\_  
Brian Mitchell

in the presence of:

  
\_\_\_\_\_  
Sarah Taylor

**Sarah Taylor**  
Senior Advisor, Integrated Schools  
Ministry of Education, Wellington

**LEGEND**

- Integrated - Blocks
- Integrated - Outdoors
- Integrated - Land

\* Block B 40% Integrated

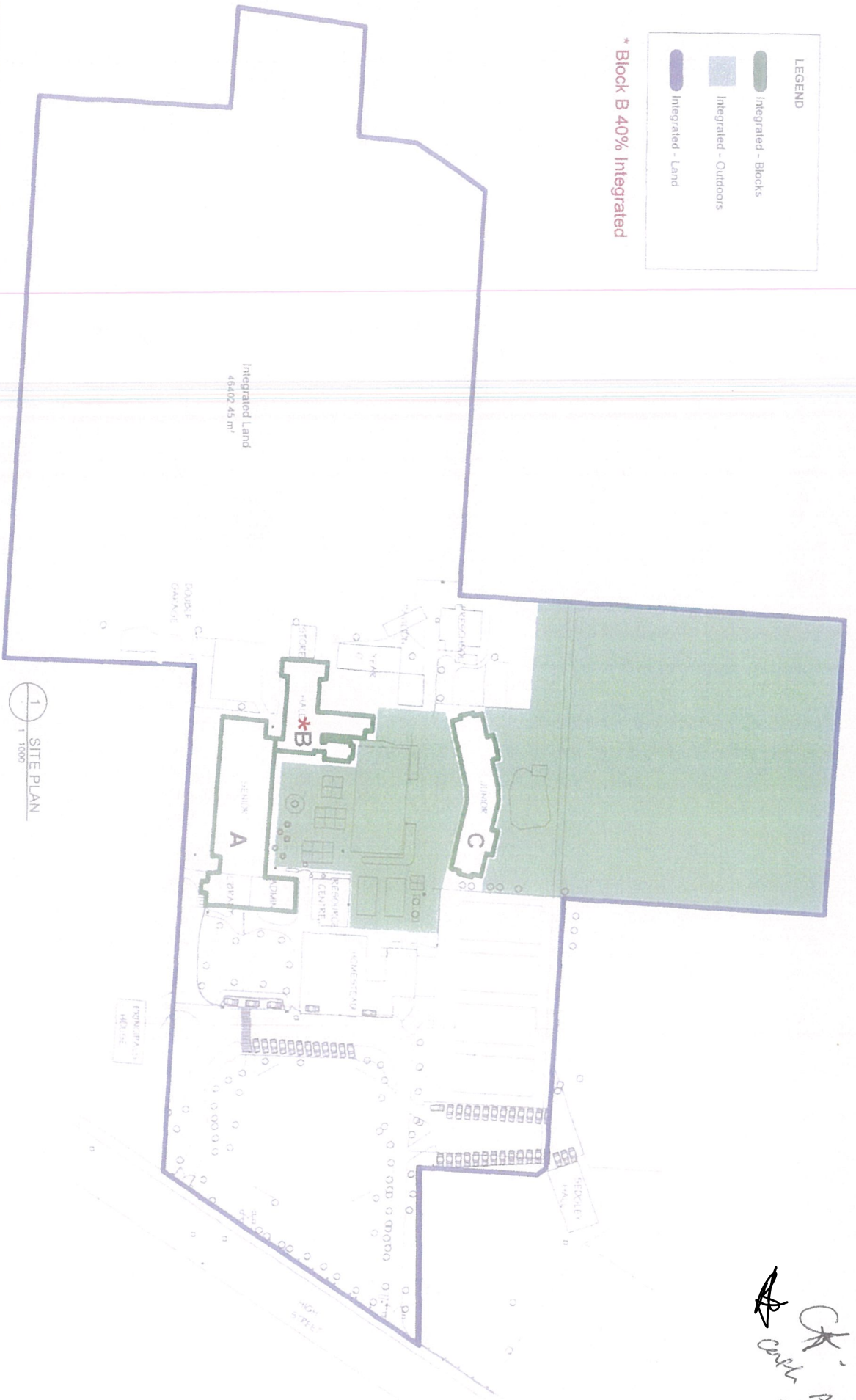

*Cath Archer  
CEO*

**Catalyst**

FOR THE HUMAN SPACE.

This drawing represents the intellectual property of Catalyst Consulting Limited and shall not be copied or distributed to any third party without prior written approval of Catalyst Consulting Ltd. Confidential documents outside per 10. All work shall conform to all relevant chapters of the New Zealand Building Code (NZBC) and NZ/AS standards.

**STATUS:**  
INFORMATION

**PROJECT:**  
HADLOW SCHOOL  
ASSET REGISTER

**ADDRESS:**  
68 HIGH STREET,  
SOLWAY,  
MASTERTON 5810

**DRAWING TITLE:**  
SITE PLAN

DRAWN	CHECKED	DATE
JOB NO. 400496	SHEET SIZE A3	03/08/20
DRAWING NO. A001	SCALE As indicated	REVISION C
WEB catalyst.co.nz		