

SUPPLEMENTARY AGREEMENT

Signed as a Deed.

This Supplementary Agreement is made on the 11 day of January 2022
between:

Her Majesty the Queen in right of New Zealand acting by and through the **Minister of Education** ("the Minister")

and

The Roman Catholic Bishop of the Diocese of Christchurch ("the Proprietor"),
together **the Parties**
in relation to **ST JOSEPH'S SCHOOL, ASHBURTON** ("the School").

Background

- A. By an Integration Agreement dated **27th April 1981** between the Minister and the Proprietor ("Integration Agreement"), the School was established as a State integrated school.
- B. The Parties have agreed to amend the Integration Agreement on the terms below. The Integration Agreement will be read subject to the modifications set out in this Supplementary Agreement from the date this Supplementary Agreement is executed by the Parties, and any references to the Private Schools Conditional Integration Act 1975 will be treated as references to the corresponding provisions of the Education and Training Act 2020.
-

Amendments

- 1 The Plan annexed to the Second Schedule of the Integration Agreement is deleted and replaced with the Plan annexed to this Supplementary Agreement.
-

P.G.M.
Initial

2 Execution

Signed on the 25 day of November 2021 by:

Archbishop Paul Martin SM, the Apostolic Administrator of the Roman Catholic Diocese of Christchurch and his Common Seal affixed:

+ P. B. Martin SM



in the presence of:

Christine Reed

Name: Christine Reed

Occupation: Personal Assistant

Location: Christchurch

By signing this Supplementary Agreement each representative of the Proprietor confirms that they have the authority to sign for and on behalf of the Proprietor, and that the Proprietor remains a corporation sole with capacity to enter into this Supplementary Agreement under clause 5(3) of Schedule 6 of the Education and Training Act 2020.

Signed on the 11 day of January 2022 by:

Her Majesty the Queen in right of New Zealand, acting by and through the Group Manager, National Property Services, acting under delegated authority from the Minister of Education:

[Signature]

in the presence of:

[Signature]

Name:

Sarah Taylor

Occupation:

**Senior Advisor, Integrated Schools
Ministry of Education, Wellington**

Location:

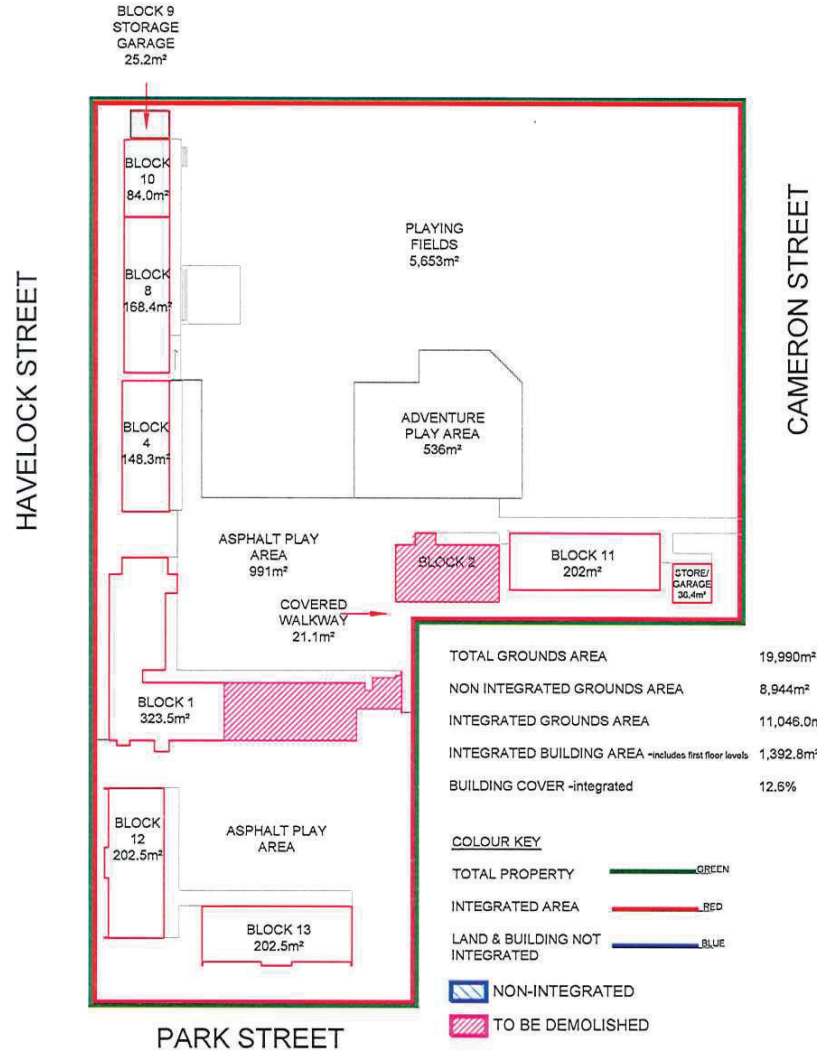

NOTES:

VERANDAH AREAS ARE NOT INCLUDED IN TOTAL BUILDING AREA OR BUILDING COVERAGE.

THIS IS A SITE AND LOCALITY PLAN AND DOES NOT PURPORT TO BE A SURVEY PLAN

REVISION	AMENDMENT	APP	DATE
R1	BLOCK 12/13, ADMIN AND LSC	DOB	JULY 2021

FINAL



wsp

Christchurch Office
+64 3 353 5400

PO Box 1482
Christchurch 8140
New Zealand

SCALES	ORIGINAL SIZE
1:750	A3

DRAWN	DESIGNED	APPROVED
A ALLISON	N/A	D O'BRIEN
DRAWING VERIFIED	DESIGN VERIFIED	APPROVED DATE
D O'BRIEN	N/A	JULY 2021

PROJECT
CATHOLIC DIOCESE OF CHRISTCHURCH
SITE AND LOCATION DRAWINGS

TITLE
ST JOSEPH'S SCHOOL ASHBURTON
SITE AND INTEGRATION PLAN
INTEGRATION PLAN

PROJECT DRAWING NO. (SUB-PROJECT)	SHEET NO.	REVISION
6-G2138.00	101	1

BLOCK & INTEGRATION PLANS