

## SUPPLEMENTARY AGREEMENT

Signed as a Deed.

This Supplementary Agreement is made on the 8th day of March 2023

between:

**His Majesty the King in right of New Zealand** acting by and through the **Minister of Education** ("the Minister")

and

**THE ROMAN CATHOLIC ARCHBISHOP OF THE ARCHDIOCESE OF WELLINGTON**  
("the Proprietor"),

together **the Parties**

in relation to **ST JOSEPH'S SCHOOL, UPPER HUTT** ("the School").

---

### Background

- A. By an Integration Agreement dated **30<sup>th</sup> June 1980** between the Minister and the Proprietor ("**Integration Agreement**"), the School was established as a State integrated school.
- B. The Parties have agreed to amend the Integration Agreement on the terms below. The Integration Agreement will be read subject to the modifications set out in this Supplementary Agreement from the date this Supplementary Agreement is executed by the Parties, and any references to the Private Schools Conditional Integration Act 1975 will be treated as references to the corresponding provisions of the Education and Training Act 2020.

---

### Amendments

- 1 The Plan annexed to the Second Schedule of the Integration Agreement is deleted and replaced with the Plan annexed to this Supplementary Agreement.
- 



2 **Execution**

Signed on the 7<sup>th</sup> day of March 2023 by:

**John Atcherley Dew**, the Roman Catholic Archbishop of the Archdiocese of Wellington  
with his seal of Office in the presence of:

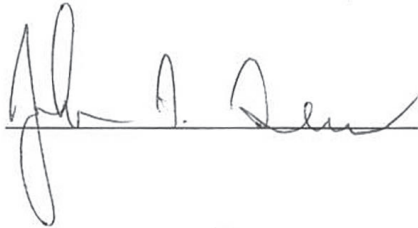

in the presence of:

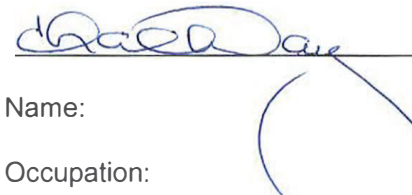
Name:

Occupation:

Location:

**T L Halliday**  
**Secretary**  
**Wellington 6021**

By signing this Supplementary Agreement each representative of the Proprietor confirms that they have the authority to sign for and on behalf of the Proprietor, and that the Proprietor remains a corporation sole with capacity to enter into this Supplementary Agreement under clause 5(3) of Schedule 6 of the Education and Training Act 2020.

Signed on the 8th day of March 2023 by: **Brian Mitchell**, Group Manager National Property Services

**His Majesty the King in right of New Zealand**, acting by and through the Group Manager, National Property Services, acting under delegated authority from **the Minister of Education**:

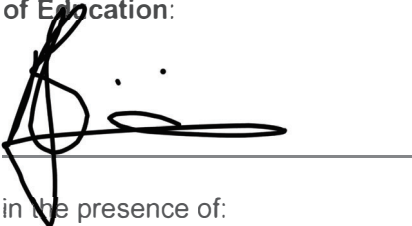

in the presence of:



**Sarah Taylor**  
Senior Advisor, Integrated Schools  
Ministry of Education, Wellington

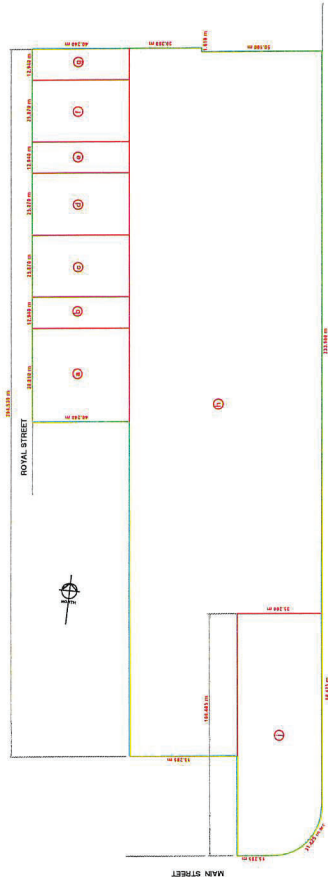

LAND INFORMATION			Area (ft <sup>2</sup> )
Percent of Acre	+	Site location	
	a	C# 10110000 SP 22500	0.049
	b	C# 030402 SP 22500	0.021
	c	C# 030402 SP 22500	0.042
	d	C# 071700 SP 22500	0.012
	e	C# 071800 SP 22500	0.012
	f	C# 071800 SP 22500	0.021
	g	C# 071800 SP 22500	0.042
	h	C# 071800 SP 22500	0.021
	i	C# 071800 SP 22500	2.323
	j	C# 071800 SP 22500	0.2446
Total Area of Land			3.538
Apprx. Area of Energy Land			3.551

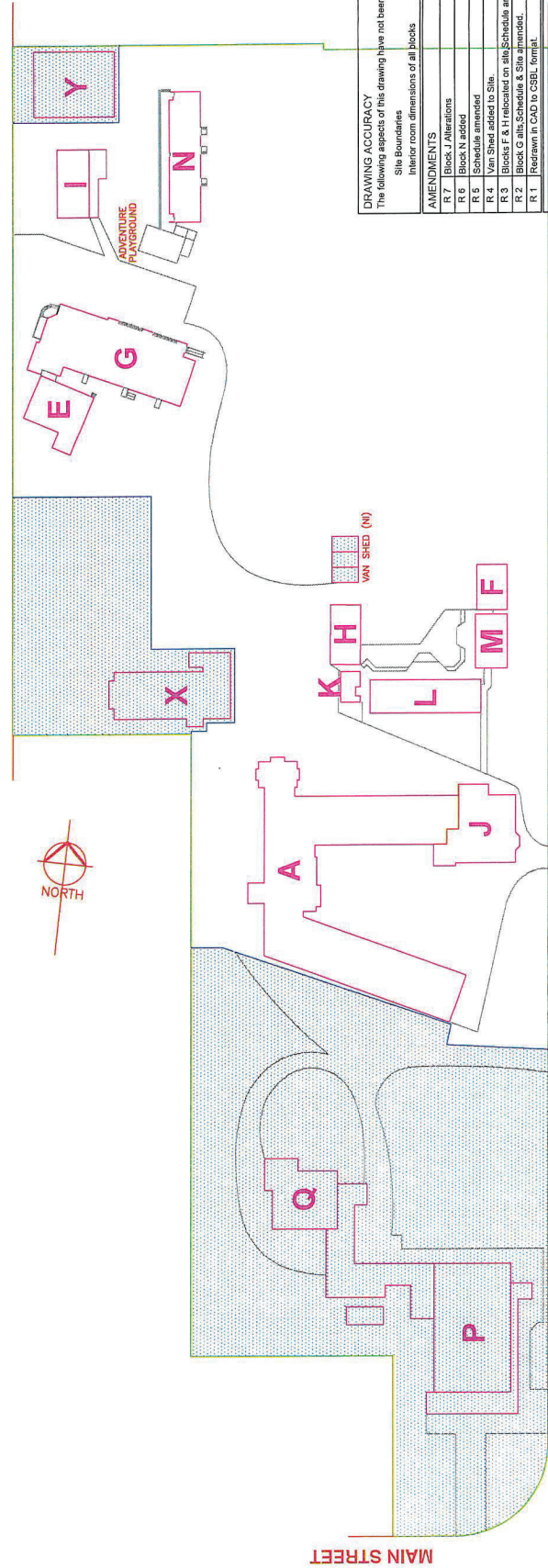
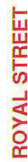

DRAWING ACCURACY	
The following aspects of this drawing have not been verified on site.	
Site boundaries	
Interior room dimensions of all blocks	
AMENDMENTS	
R 7	Block J Alterations
R 6	Block N added
R 5	Schedule amended
R 4	Block N amended
R 3	Van Street added to Site.
R 3	Block F is relocated on site. Schedule amended.
R 2	Block G is Schedule A site amended.
R 1	Redrawn in CAD to CSBL format.
	BSN 1022
	BSN 6/22
	BSN 6/20
	BSN 6/18
	BSN 2/14
	BSN 5/02
	BSN 5/09

LEGEND	
Non-Integrated Land and Buildings	
Shared Land	
Proprietors Land	

ER PLAN	Scale = 1:500 @ A1	<div> <div>1</div> <div>of 2 sheets</div> <div>REVISION R7</div> </div>
<div> <div>No: 3011</div> <div>No: 430</div> </div>	<div> <div>Original Dwg Created 509</div> <div>Last revision Date 10/22</div> </div>	