

SUPPLEMENTARY AGREEMENT

Signed as a Deed.

This Supplementary Agreement is made on the 26 day of October 2021

between:

Her Majesty the Queen in right of New Zealand acting by and through the **Minister of Education** ("the Minister")

and

The Apostolic Administrator of the Diocese of Palmerston North (Inc) ("the Proprietor"),

together **the Parties**

in relation to **ST JOSEPH'S SCHOOL, WAITARA** ("the School").

Background

- A. By an Integration Agreement dated **8th October 1980** between the Minister and the Proprietor ("**Integration Agreement**"), the School was established as a State integrated school.
- B. The Parties have agreed to amend the Integration Agreement on the terms below. The Integration Agreement will be read subject to the modifications set out in this Supplementary Agreement from the date this Supplementary Agreement is executed by the Parties, and any references to the Private Schools Conditional Integration Act 1975 will be treated as references to the corresponding provisions of the Education and Training Act 2020.

Amendments

- 1 The Plan annexed to the Second Schedule of the Integration Agreement is deleted and replaced with the Plan annexed to this Supplementary Agreement.



Initial

2 Execution

Signed on the 26 day of October 2021 by **Cardinal John Atcherley Dew** the Apostolic Administrator of the Diocese of Palmerston North with his seal of Office in the presence of:

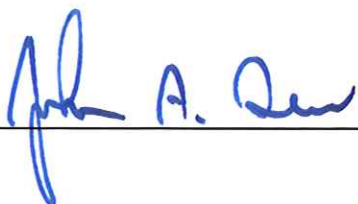
 Trustee

Trustee



in the presence of:



Name:

Occupation:

Location:

T. L. Halliday
Secretary
Wellington 6021

By signing this Supplementary Agreement, each representative of the Proprietor confirms that s/he has the authority to sign for and on behalf of the Proprietor, and that the Proprietor remains a body corporate with capacity to enter into this Supplementary Agreement clause 5(3) of Schedule 6 of the Education and Training Act 2020.

Signed on the 9th day of November 2021 by:

Signed on behalf of

Her Majesty the Queen in right of New Zealand, acting by and through the Group Manager, National Property Services, acting under delegated authority from **the Minister of Education**:

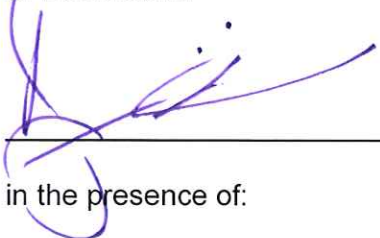

in the presence of:



Name:

Occupation:

Location:

Sarah Taylor
Senior Advisor, Integrated Schools
Ministry of Education, Wellington

CONSTRUCTION DATA	DATE	ALTERATIONS & ADDITIONS	ASIA	CONSTRUCTION DETAILS
BLOCK BUILDING USE	1950			Permanent concrete piles & also, timber framing, woodwork, etc.
A CLASSROOMS & ADMIN				
		Admin Upgrade	2002	
		Staffroom Extension	2009	
		Admin addition & alterations	2014	
				Timber piles, framing, concrete floor cladding, gully, iron roof, Block foundation walls, timber posts, cladding, iron roof, cladding, Corroborated & Membrane roofing
		Classroom Demolished, replaced with admin. room	2020	
B UNIT CHS	1978			Reconstructive concrete frame cladding, gully, iron roof
		New floor	2020	
C TOILET BLOCK	1958			
D TOILET BLOCK	1958			
F CHANGING SHEDS				
		New Roof and Ceiling	2020	
G CARETAKERS	1950			
K GLEANERS	1958			
L STORE / PUMP SHED	1950			
M CHEM STORE	1958			
N CLASSROOM	2011			
		Building Demolished		
O CLASSROOM	2014			
		Building Demolished	2019	
				Reconstructive timber pile, timber framed, iron panel/iron weatherboard cladding, gully, iron roof
1 POOL				
CW COVERED WAYS	1958			
		Building Demolished	2019	
				4.9 x 13.7m
				102 sq. m

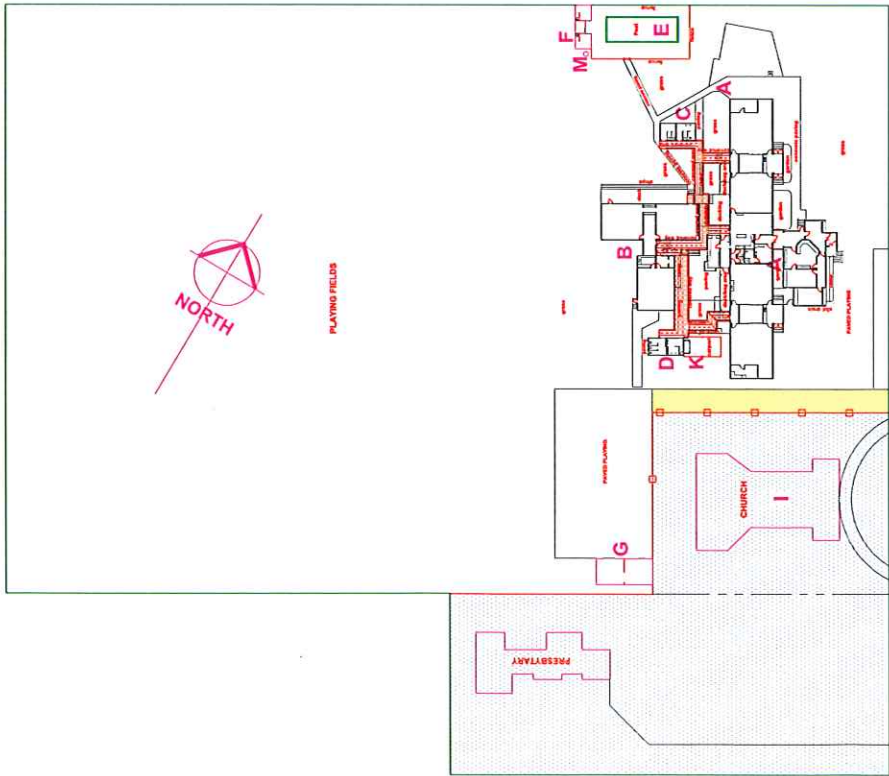

NELSON STREET

LOCALITY AND LAND PLAN

Scale 1:1000

LAND INFORMATION	
Parcel of Land	Title References
a	CT 180/79 Lots 2 & 3, DP 6937, Pt. Sect. 28 Waitara West District
b	CT 1/1020 DP 10316, Pt. Sect. 28 Waitara West District
Total Area of Land = 2.2905	
Approx. Area of Integrating Land = 1.8206	

DRAWING ACCURACY
The following aspects of this drawing have not been verified on site.

Site Boundaries
Interior room dimensions of all blocks

AMENDMENTS	
R 4	Block L, N & O removed Block A Classroom demolition & Alter.
R 3	Classroom Block Q added, Block A Addition & Alter.
R 2	Classroom Block N added, Covered way Legend.
R 1	Admin remodel, staffroom alterations/exclusion
R 0	Redrawn in CAD to CSB format-Admin Classroom Alter.

LEGEND

Non-Integrated Land and Buildings
Shared Land
Proprietors Land
Covered ways

ASSET REGISTER PLAN

Scale = 1:500 @ A1

Original Dwg Created 7/07

Last revision Date 7/21

SITE PLAN

ST. JOSEPH'S SCHOOL, WAITARA

MOE SCHOOL PROFILE No: 2239

DPN SCHOOL No: 30

DIOCESE OF PALMERSTON NORTH

33 Amesbury Street, Private Bag 11 012, Palmerston North

Telephone 06 354 1780 E-mail: srentveid@ndioocese.org.nz

ASSET PLAN MANAGER'S

BSM Group Architects

33 Ragway St WANGANUI

Phone (06) 345 8112 Fax (06) 345 3461

E-mail: admin@bsmgroup.co.nz

ASSET REGISTER PLAN

Scale = 1:500 @ A1

Original Dwg Created 7/07

Last revision Date 7/21

SHEET

1

of 2 sheets

REVISION R4