

**SUPPLEMENTARY DEED OF AGREEMENT****CORNERSTONE CHRISTIAN SCHOOL, PALMERSTON NORTH**

THIS DEED OF AGREEMENT is made on the <sup>28<sup>th</sup></sup>~~22<sup>nd</sup>~~ day of <sup>September</sup>~~August~~ two thousand and eighteen (2018) BETWEEN **the Cornerstone Christian Education Trust** (the Proprietor") of the first part and **Her Majesty the Queen** acting by and through the Minister of Education (hereinafter referred to as "The Minister") of the second part.

**WHEREAS**

- A By Deed of Agreement bearing date the 9<sup>th</sup> day of September 1994 as varied by any subsequent supplementary agreements (hereinafter referred to as "the Deed of Agreement"), the Minister and the Proprietor pursuant to section 7(2) of the Private Schools Conditional Integration Act 1975 established **Cornerstone Christian School, Palmerston North** as an integrated school (hereinafter referred to as "the School").
- B The Proprietor and the Minister wish to vary the Deed of Agreement to replace the Plan attached to the Second Schedule with a new Plan pursuant to section 423(3) of the Education Act 1989.

**NOW THIS DEED OF AGREEMENT WITNESSETH THAT IT IS HEREBY COVENANTED AGREED AND DECLARED BY AND BETWEEN THE PARTIES HERETO AS FOLLOWS:**

- 1 **THAT** the Plan annexed to the Second Schedule of the Deed of Agreement be deleted and the Plan annexed here to be substituted therefor.
2. **THAT** the covenants conditions and restrictions contained and implied in the Deed of Agreement shall be read and construed subject to the modifications herein contained but in all other respects the Deed of Agreement is confirmed.



IN WITNESS WHEREOF these presents have been executed the day and year first hereinbefore written.

**THE COMMON SEAL OF**  
**Cornerstone Christian Education Trust**  
 was hereunto affixed in the presence of:



*Brian Gray*  
 .....  
*Brian Gray*

*Devin de Groot*  
 .....  
*Devin de Groot*

*[Signature]*  
 .....

Witness signature

Witness name *RICHARD JOHN TANKERSLEY*

Occupation *DIRECTOR*

City/Town of residence *141 HARRISONS LINE  
 PARMERSTON NORTH 4470*

Signed by *Brian Mitchell*  
 Group Manager, Ministry of Education  
 pursuant to authority delegated by  
 the Minister of Education acting on behalf of  
**HER MAJESTY THE QUEEN**  
 in the presence of:

*[Signature]*

**Sarah Taylor**  
 Senior Advisor, Integrated Schools  
 Ministry of Education, Wellington



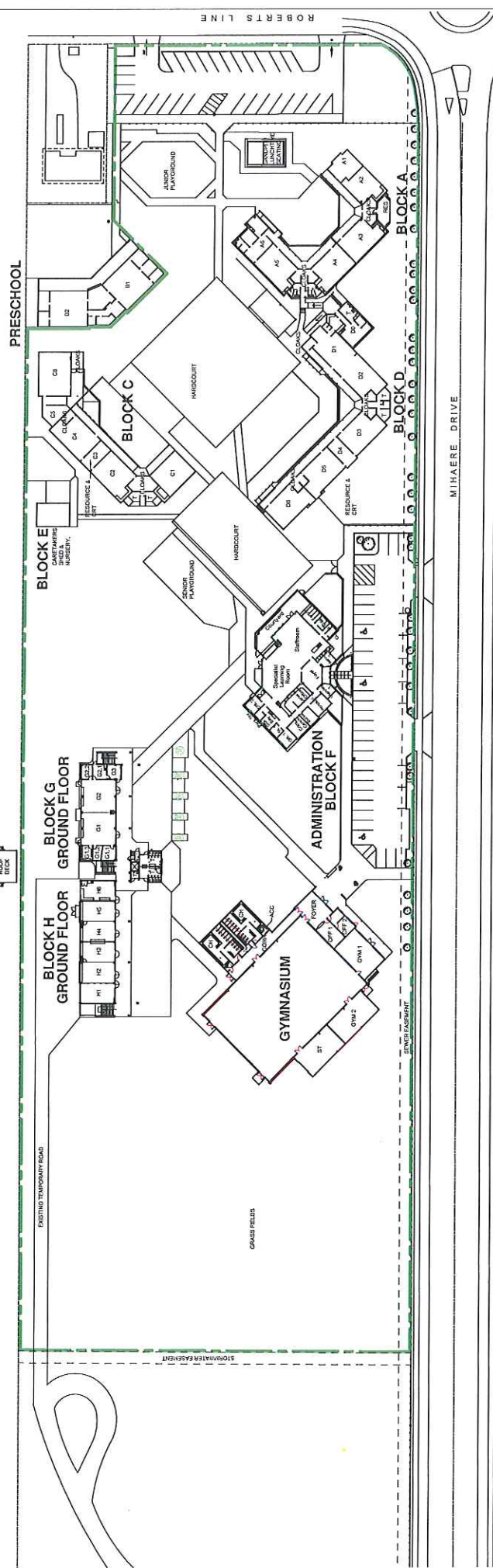
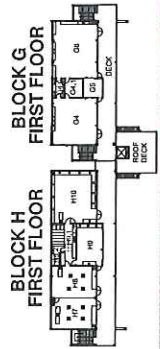

**SITE INFORMATION**

LOT 2  
DP 42726

TOTAL SITE AREA = 5.7752 HECTARES  
INTEGRATED LAND AREA = 3.8 HECTARES

SENIOR PLAYGROUND SUBJECT TO AN EQUITABLE LEASE  
BETWEEN PROARCH AND THE COUNCIL OF DISTRICTS  
B.O.T DATED 15/05/03

INTEGRATED AREA BOUNDARY

Date	No.	Revised
<b>Proarch</b> Cornerstone Christian School 119 Mihaere Drive Palmerston North SITE PLAN		
Drawn	Checked	Approved
5271	5271	5271
Scale	1:500	Scale
Sheet	1	SP1

*[Handwritten signature]*



THIS PRINT IS THE EXCLUSIVE PROPERTY OF PROARCH ARCHITECTS LIMITED. IT SHALL NOT BE TRACED, COPIED OR REPRODUCED OR USED IN ANY MANNER WITHOUT THE WRITTEN PERMISSION OF PROARCH ARCHITECTS LIMITED. ALWAYS JOB CHECK LINES AND DIMENSIONS ON SITE.

